

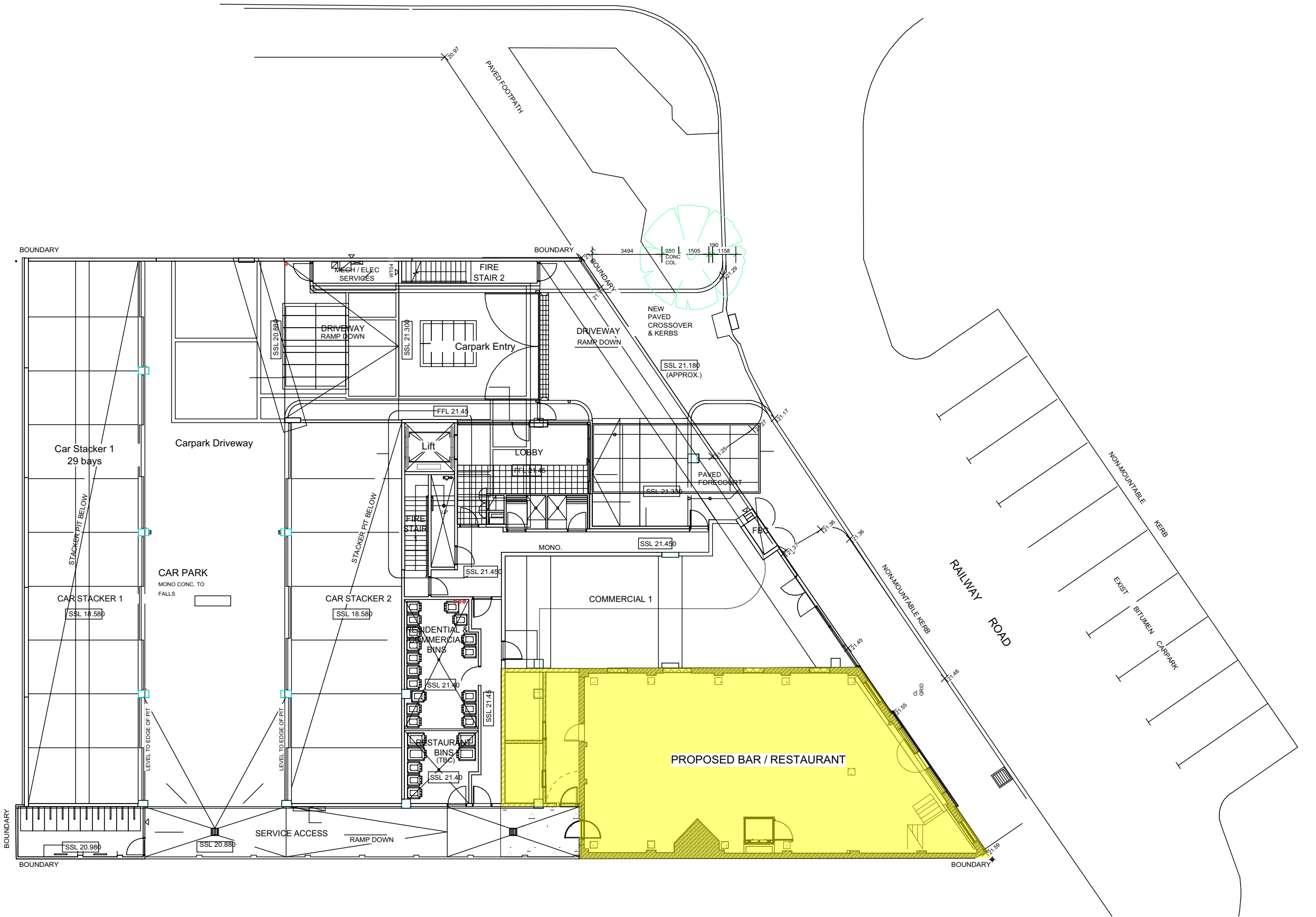

1
601

SITE MAP

17-23 RAILWAY RD.
SITE OF PROPOSED VENUE



2
601

DEVELOPEMENT SITE PLAN

1:200

NOTE: CONSTRUCTION DRAWINGS
ALL DIMENSIONS ARE IN MILLIMETRES. THIS IS A VECTORWORKS
GENERATED DRAWING AND SHOULD NOT BE SCALED FROM. ENSURE THE
DRAWINGS ARE PRINTED TO SCALE BY CHECKING THE PAGE SIZE IN TITLE
BLOCK BOTTOM RIGHT CORNER. VERIFY ALL DIMENSIONS ON SITE BEFORE
COMMENCING ANY WORKS OR SHOP DRAWING OR ORDERING MATERIALS.

ISSUE 3	11.02.2016	FOR APPROVAL & BUILDER QUOTE	AC
REVISION B	11.02.2016	UPDATE ANNOTATIONS	AC

PROJECT
PROPOSED BAR / RESTAURANT
ADDRESS
17-23 RAILWAY ROAD
SUBIACO PERTH 6008
CLIENT
STRICTLY STRAWBS PTY LTD

PROPOSED DEVELOPEMENT SITE MAPS

project **BLAK**
39 Newcastle Street
Northbridge
Perth WA 6000
BRITTNEY GIBBS
AMY CUMMING
0422 107 374
0424 792 276

All designs & drawings remain the property of project blak. Designs and drawings can
not be disclosed, copied, copied, used for manufacture or any purpose without written
consent from project BLAK.

PROJECT # 069	SUBIACO DRAWINGS PACKAGE 031215.vmx	REVISION B
DWG DATE 03.12.15	DRAWING No.	601
SCALE 1:50 @ A2		
DRAWN AC	CHKD BG	